

Boundaries of CFD No. 2006-1

PROPOSED BOUNDARY MAP OF
COMMUNITY FACILITIES DISTRICT NO. 2006-1
(SONORA WELLS)

CITY OF INDIO
COUNTY OF RIVERSIDE
STATE OF CALIFORNIA

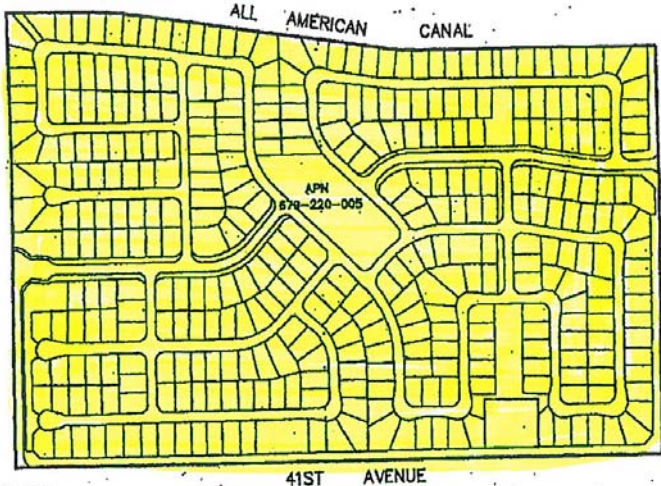
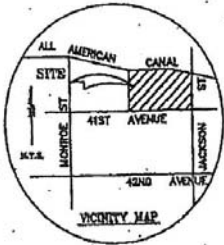

FILED IN THE OFFICE OF THE CITY CLERK OF THE CITY OF INDIO THIS 19th DAY OF JUNE, 2006.

I HEREBY CERTIFY THAT THE VESTED MAP SHOWING PROPOSED BOUNDARIES OF CITY OF INDIO COMMUNITY FACILITIES DISTRICT NO. 2006-1 (SONORA WELLS), CITY OF INDIO, COUNTY OF RIVERSIDE, STATE OF CALIFORNIA, WAS APPROVED BY THE CITY COUNCIL OF THE CITY OF INDIO AT A REGULAR MEETING THEREOF, HELD ON THE 17th DAY OF JUNE, 2006, BY ITS RESOLUTION NO. 2006-007.

Christine Kennedy
CITY CLERK
CITY OF INDIO

FILED THIS 21st DAY OF JUNE, 2006, AT THE HOUR OF 8 O'CLOCK P.M. IN THE BOOK 1434 PAGE 111 OF MAPS OF ASSIGNMENT AND COMMUNITY FACILITIES DISTRICTS IN THE OFFICE OF THE COUNTY RECORDER IN THE COUNTY OF RIVERSIDE, STATE OF CALIFORNIA. File # 2006-0459-460

Shirley J. Truitt, Deputy
COUNTY RECORDER
COUNTY OF RIVERSIDE
STATE OF CALIFORNIA

LARRY W. WARD - COUNTY ASSESSOR - CLERK - RECORDER
THE LINES AND DIMENSIONS OF EACH LOT OR PARCEL SHOWN ON THIS MAP SHALL BE THESE LINES AND DIMENSIONS AS SHOWN ON THE RIVERSIDE COUNTY ASSESSOR'S MAPS FOR THOSE PARCELS LISTED.

THE RIVERSIDE COUNTY ASSESSOR'S MAPS SHALL GOVERN FOR ALL DETAILS CONCERNING THE LINES AND DIMENSIONS OF SUCH LOTS OR PARCELS.

LEGEND
CFD BOUNDARY

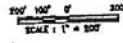

MuniFinancial
17750 Via Indivista
Suite 210
Temecula, California 92590-1561
Phone (951) 267-0100 Fax (951) 267-0810

(02-132) DECEMBER 2005